

INSTALLATION GUIDE: WIDESPREAD MOUNTED LAVATORY FAUCET

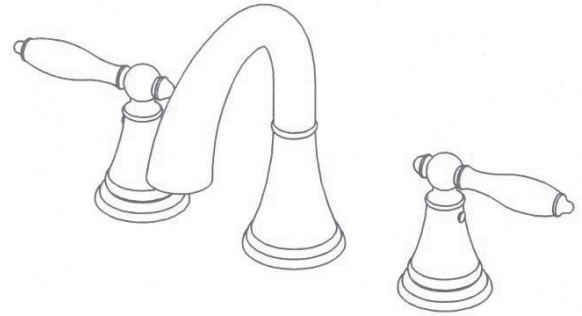

PRODUCT SPECS AND STANDARDS:

DESCRIPTION:

- Machined brass bodies
- Cast brass spout
- (3) Hole diameter sizes = 1-1/4" Min., 1-1/2" Max.
- Center distance between holes = 3" Min. (6" between Hot and Cold valves)
- Surface thickness = 1" Max.

OPERATION:

- Requires less than 5LB force to operate valve
- Flow adjustment: 90° turn from full off to full on
- 1.2 GPM (4.5 L/min) Aerator

PRODUCT SPECS AND STANDARDS:

STANDARDS:

- IAPMO/UPC Certified:
- ASME A112.18.1-2012/CSA B 125.1-12
- NSF/ANSI 61-2012
- NSF/ANSI 372-2011 (Lead Free)
- Watersense approved

WARRANTY:

- 25 Year drip-free warranty
- Product to be free of defects in material or workmanship

NOTE:

While your faucet may differ in appearance to item shown, it will install with in the same manner.

CLEANING INSTRUCTIONS:

Use only a clean, soft cloth, water, and mild hand soap to clean unit.

WARNING: Do NOT use abrasive cleaners, chemicals, or abrasive cleaning pads to clean fixture. A very hard protective coating has been applied to this product to maintain it's appearance, but this product could be damaged with improper cleaning. Failure to follow cleaning instructions will void product warranty.

PRODUCT WARRANTY:

Windon Bay faucets have been manufactured to our high quality standards and workmanship. **The warranty covers defects in materials and/ or workmanship to the original purchaser/home owner (warranty is not transferable to another person).** The faucet is warranted to remain drip-free during normal use. All parts and finishes will be free from manufacturing defects. With the exception of items listed below, this product has a limited warranty against defects in materials or workmanship for a period of 1 year from the date of purchase. The warranty is voided if the product is found to be misused or the following cleaning instructions were not followed. Damage due to accidents or installation is not warranted.

1. Faucet valve cartridges have a limited warranty for a period of 25 years from the date of purchase. This date is stamped on the valve cartridge.
2. Product finish has a limited warranty for a period of 25 years from the date of purchase. Failure to follow the cleaning instructions listed below voids all finish warranty. Damage due to accidents or installation is not warranted.

This warranty covers replacement of cartridges, parts and finish only. It does not include labor charges and/or damage incurred during installation. Windon Bay will provide free of charge all parts and cartridges found to be covered under the warranty; any part that proves defective in material and/or workmanship under normal installation, use and service. Finish warranty is not covered if finish is exposed to extreme use of cleaners containing abrasives and alcohol, extreme cleaning, extreme chemical use, or any damage due to abuse or neglect (Oil Rubbed Bronze and Matte Black finish is warranted for 1 year).

**Please see cleaning instructions provided with each faucet. This warranty excludes all industrial, commercial, and business usage of faucets and only pertains to single dwelling residential use. Faucets used for other than single dwelling residential use are covered by a 1-year limited warranty from the date of purchase.

HELPFUL TOOLS

Phillips Screwdriver

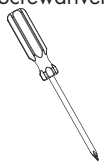

Hex Key Wrench

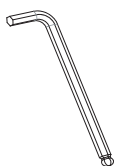

Adjustable Wrench



Safety Glasses



Plumber's Putty



Tubing Cutter

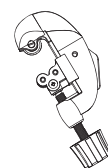

Supply Hoses



INSTALLATION GUIDE: WIDESPREAD MOUNTED LAVATORY FAUCET

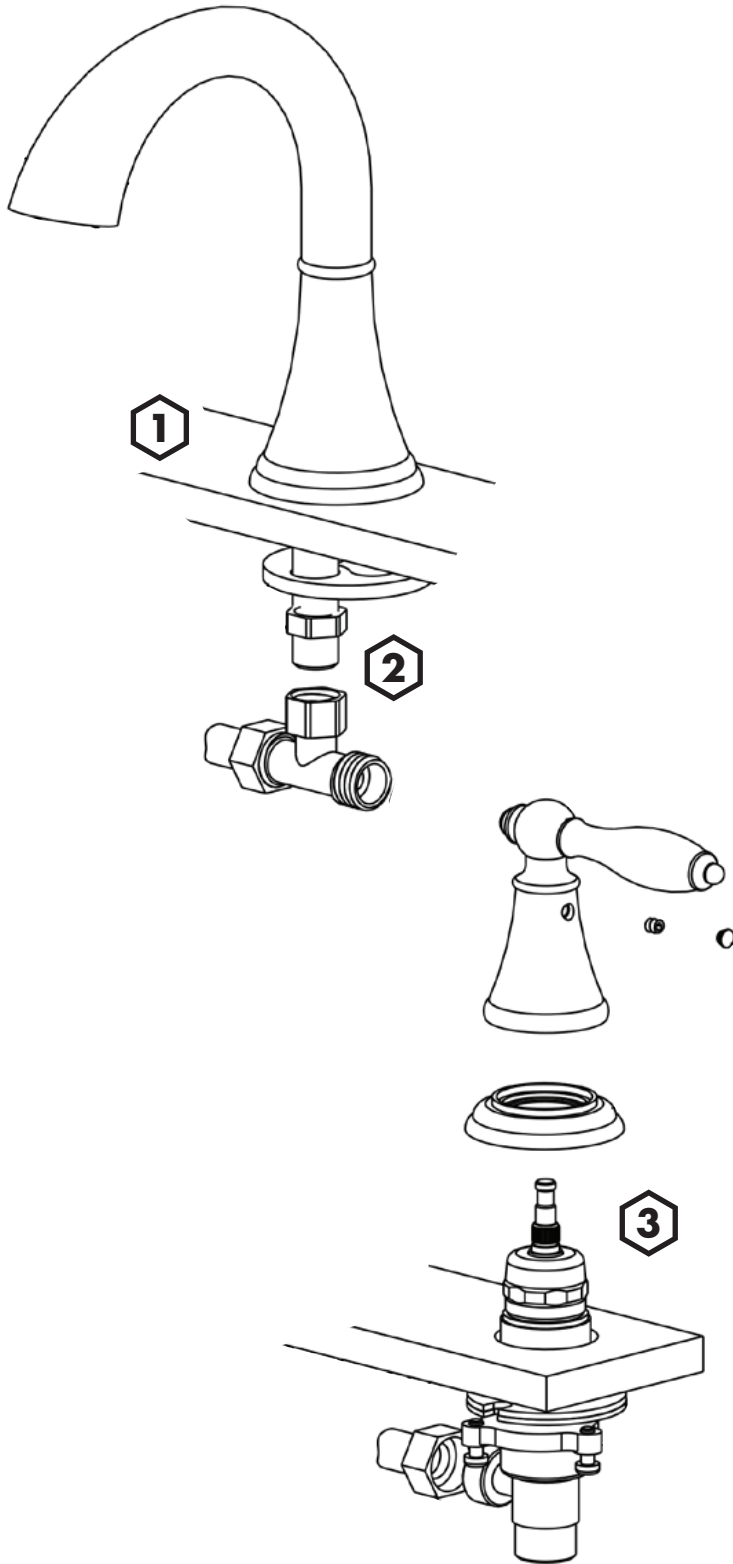

1

TURN OFF WATER SUPPLIES.

Ensure mounting surface requirements are as follows:

- Three (3) Hole diameter sizes = 1-1/4" Min., 1-1/2" Max.
- Center distance between holes = 3" Min. (6" between Hot and Cold valves)
- Surface thickness = 1" Max.

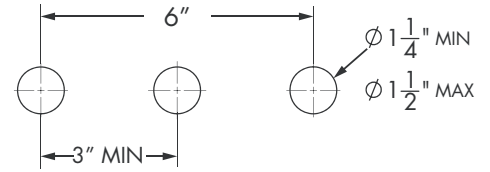

2

SPOUT INSTALLATION:

Remove Mount Nut and Mount Bracket from spout assembly. Assemble Spout to sink surface. Re-assemble spout Mount Nut and Mount Bracket to Spout Shank and tighten. Assemble Spout Tee (with washer) to Spout Shank and tighten.

3

VALVE BODY INSTALLATION:

Remove Handles and Flanges from valve body assemblies. From bottom side of sink, insert Valve Bodies with Mount Nuts/Washers through surface holes. From top side of sink, assemble Flanges onto bodies and hand tighten. Tighten body Mount Nuts and Screws to secure valve bodies. Reassemble Handle to Valve body ensuring proper alignment in the "OFF" position.

INSTALLATION GUIDE: WIDESPREAD MOUNTED LAVATORY FAUCET

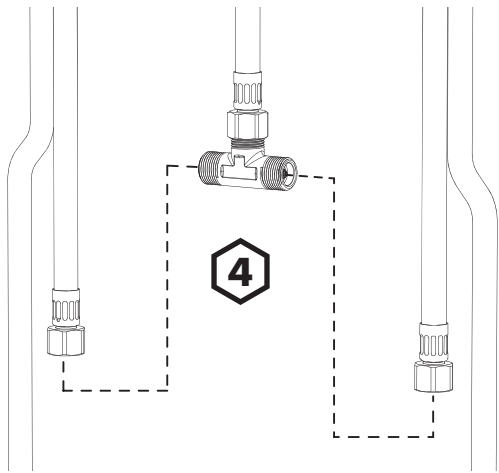

4

ASSEMBLE WATER SUPPLY LINES.

Connect Widespread Hoses from bodies to Spout Tee and tighten. Connect water supply lines to valve bodies and tighten.

5

PREPARE AND INSTALL POP UP DRAIN ASSEMBLY

When assembling pop-up drain assembly to sink, apply plumbers putty to bottom of flange, silicon sealant between mack washer and threads. Apply thread sealant to tailpiece threads.

OR

5

PREPARE AND INSTALL LIFT ROD DRAIN ASSEMBLY

From beneath, insert Drain Assembly through drain hole in sink. Attach supplied Flange Washer or plumber's putty to the underside of the Flange. Secure Flange to the Drain Assembly. From beneath, tighten mounting nut. Place one end of Spring Clip, on Pivot Rod. Insert Pivot Rod through a hole in the Lift Rod Strap. Secure with Spring Clip. Place Drain into the open position by pressing downward on the Pivot Rod. Insert Lift Rod into Strap. Adjust height of Lift Rod, and tighten Thumb Screw.

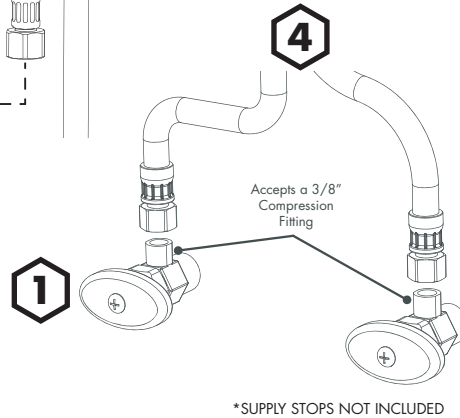

*SUPPLY STOPS NOT INCLUDED

5 POP UP DRAIN ASSEMBLY

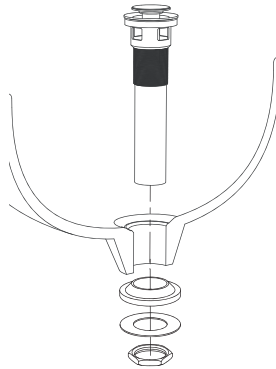

5 LIFT ROD DRAIN ASSEMBLY

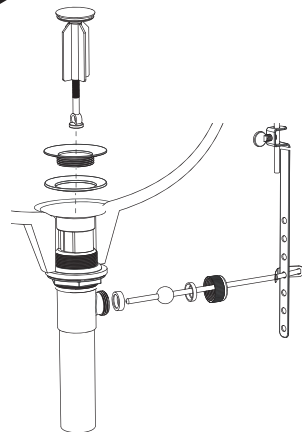

6

TURN ON WATER AND FLUSH THE SYSTEM.

Remove aerator (if installed) using aerator key and flush thoroughly to remove any debris. Re-install aerator.

7

CONFIRM PROPER INSTALLATION

Check for leaks and proper operation of faucet.

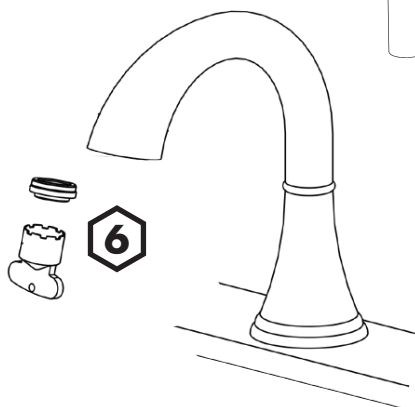

CALIFORNIA PROPOSITION 65:

WARNING: This product can expose you to chemicals including lead, which is known to the State of California to cause cancer and birth defects or other reproductive harm. For more information go to [www. P65Warnings.ca.gov](http://www.P65Warnings.ca.gov).

Wash hands after installation, repair, or removal of this product.